

US Hwy 68

Front Entrance (from US Hwy 68)

Maysville Campus

1. Finch Library, A-274
2. Hayswood Literacy Center, A-275
3. Student Support Services, A-314 (upper level)
4. Crockett Auditorium, A-268
5. Campus Operator, A-259
6. Scholarships, A-256c
7. Testing Center, A-305 (upper level)
8. Tutoring Lab, A-260
9. Master Advising/Transfer Center, A-257
10. Early College Dual Credit, A-251
11. Ready to Work, D-245
12. Business Office/Cashier, C-205 (upper level)
13. Fields Auditorium, C-207 (upper level)
14. Workforce Solutions and Career Services, C-209
15. Bookstore, C-103 (lower level)
16. Student Center/Cafe, C-102 (lower level)
17. Enrollment Center and Student Records, T-101
18. Financial Aid, T-102

Parking Lot A

Parking Lot B

Science Bldg. Parking Lot

Parking Lot C

Parking Lot D

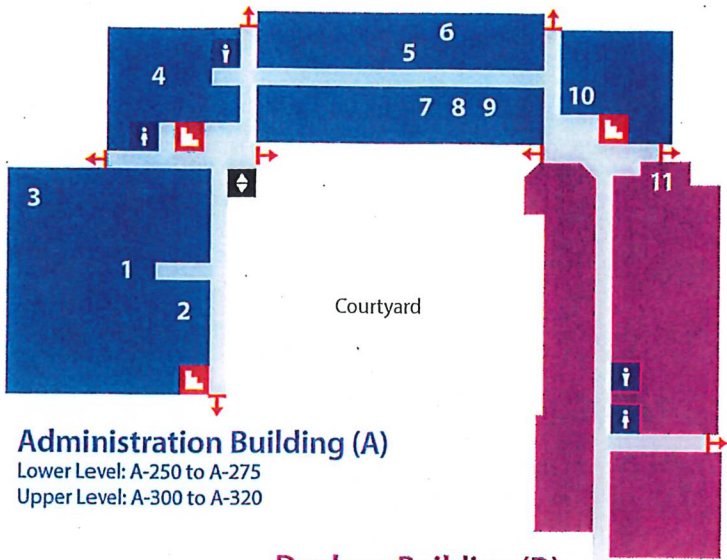

Denham Building (D)
Ground Level: D-230 to D-245

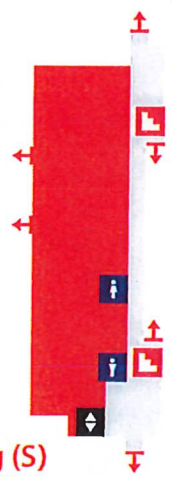

Calvert Building (C)
Lower Level: C-102 to C-112
Upper Level: C-201 to C-225

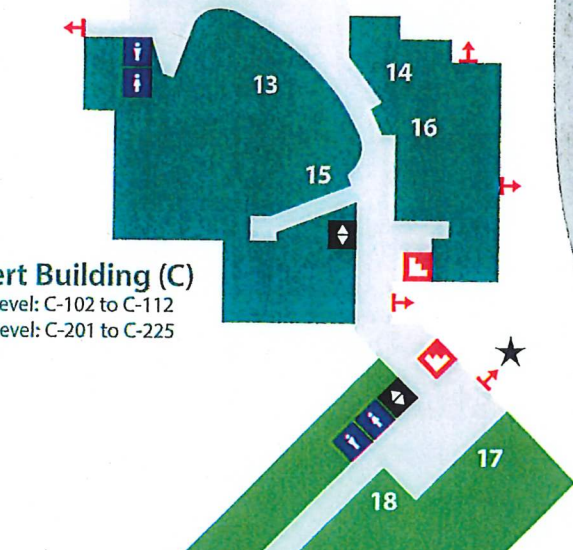

- ★ Main Entrance Enrollment Center
- ⋮ Hallway
- ⌂ Stairs
- ↔ Exit
- ⬆ Elevator
- ♿ Restroom
- 🚗 Parking
- 🛣 Road

Emergency evacuation procedures posted in every classroom and office suite.

Rear Entrance (from Martha Comer Drive)